

High Voltage Diodes - Surface Mount

0.42A • 30ns

ELECTRICAL CHARACTERISTICS AND MAXIMUM RATINGS													
Part Number	Working Reverse Voltage (V _{rw})	Average Rectified Current (I _o)		Reverse Current @ V _{rw} (I _r)		Forward Voltage (V _f)		1 Cycle Surge Current t _p =8.3ms (I _{fsm})	Repetitive Surge Current (I _{frm})	Reverse Recovery Time (3) (T _{rr})	Thermal Impd. θ _{J-L}	Junction Cap. @50VDC @1kHz (C _j)	Markings
		55°C(1)	100°C(2)	25°C	100°C	25°C	25°C	25°C	25°C	25°C	25°C	25°C	
	Volts	Amps	Amps	µA	µA	Volts	Amps	Amps	Amps	ns	°C/W	pF	
SXF20FF3	2000	0.42	0.21	1.0	20	7.5	0.42	16	3	30	20	4.0	X20FF3
(1)TC=55°C (2)TC=100°C (3)I _f =125mA, I _r =250mA, I _{rr} =63mA *Op. Temp.= -65°C to +175°C Stg. Temp.= -65°C to +200°C													

Tolerance:
.XXX ±.005

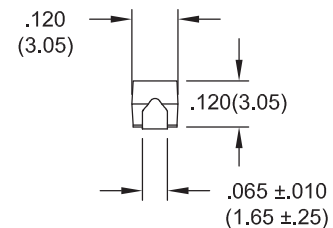
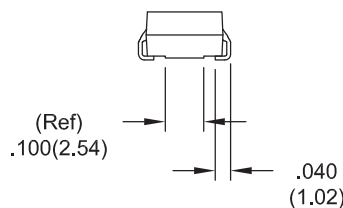
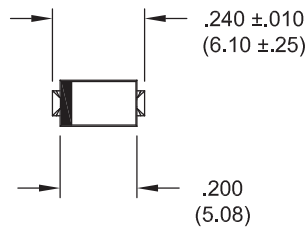
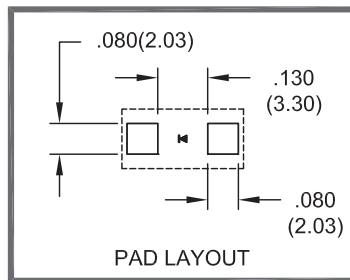

Dimensions: In. (mm) • All temperatures are ambient unless otherwise noted. • Data subject to change without notice.



Voltage Multipliers Inc.

8711 W. Roosevelt Ave.
Visalia, CA 93291 USA

Tel: 559.651.1402
Fax: 559.651.0740

www.voltagemultipliers.com
www.highvoltagepowersupplies.com

SXF20FF3

1

