

# High Voltage Diodes - Surface Mount

Revised Date: 08-05-20

**0.42A • 30ns**

## ELECTRICAL CHARACTERISTICS AND MAXIMUM RATINGS

| Part Number | Working Reverse Voltage<br>(V <sub>rw</sub> ) | Average Rectified Current<br>(I <sub>o</sub> ) |          | Reverse Current @ V <sub>rw</sub><br>(I <sub>r</sub> ) |         | Forward Voltage<br>(V <sub>f</sub> ) |      | 1 Cycle Surge Current<br>I <sub>p</sub> =8.3ms<br>(I <sub>fsm</sub> ) | Repetitive Surge Current<br>(I <sub>frm</sub> ) | Reverse Recovery Time<br>(3)<br>(T <sub>rr</sub> ) | Thermal Impd.<br>$\theta_{(J-L)}$ | Junction Cap.<br>@ 50VDC<br>@ 1kHz<br>(C <sub>j</sub> ) |
|-------------|---|--|----------|--|---------|--------------------------------------|------|---|---|--|-----------------------------------|---|
|             |   | 55°C(1)  | 100°C(2) | 25°C   | 175°C   | 25°C                                 | 25°C |   |   |  |                                   |   |
|             | Volts   | Amps   | Amps     | $\mu$ A  | $\mu$ A | Volts                                | Amps | Amps  | Amps  | ns   | °C/W                              | pF  |
|             | SXF20FF3HT                                    | 2000   | 0.42     | 0.21   | 0.1     | 25                                   | 7.5  | 0.42  | 16  | 3  | 30                                | 20  |

(1) TL=55°C (2) TL=100°C (3) I<sub>f</sub>=125mA, I<sub>r</sub>=250mA, I<sub>rr</sub>=63mA \*Op. Temp.= -65°C to +175°C Stg. Temp.= -65°C to +200°C



Tolerance:  
.XXX ±.005(.13)

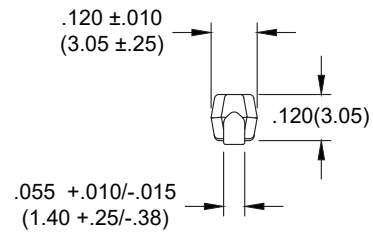
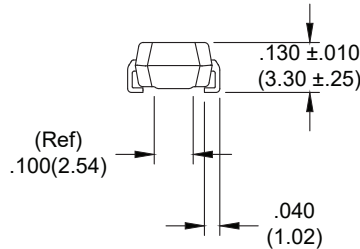
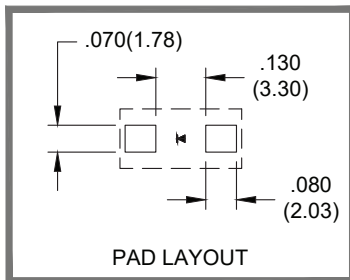
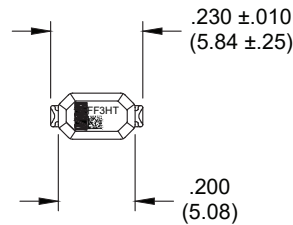
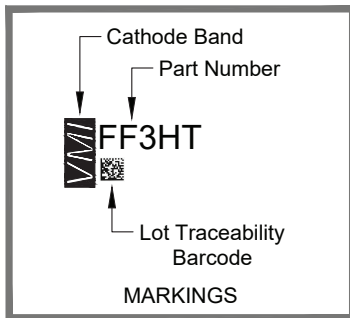

.055 +.010/-.015  
(1.40 +.25/-.38)

Dimensions: In. (mm) • All temperatures are ambient unless otherwise noted. • Data subject to change without notice.



Voltage Multipliers Inc.

8711 W. Roosevelt Ave.  
Visalia, CA 93291 USA

Tel: 559.651.1402  
Fax: 559.651.0740

[www.voltagemultipliers.com](http://www.voltagemultipliers.com)  
[www.highvoltagepowersupplies.com](http://www.highvoltagepowersupplies.com)